

 **BLAUPUNKT**

**TRUE WIRELESS**

BTW-PRO

Google/Siri Assist | Dual Mic

**QUICK START**

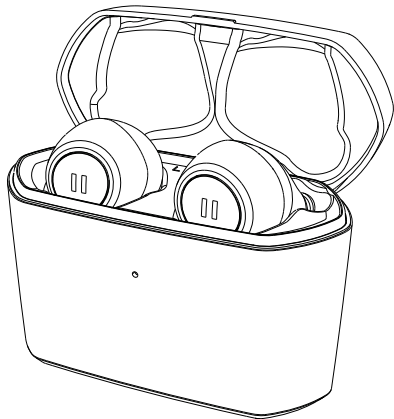

## Pair and connect

### 1 Power on / off

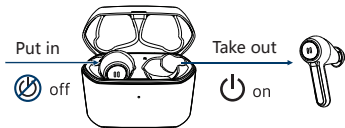

### 2 Remove to pair

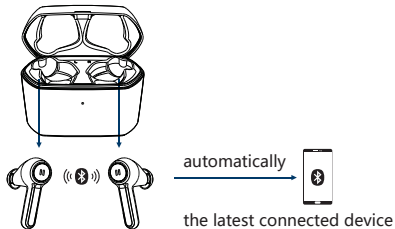

### 3 First-time pair

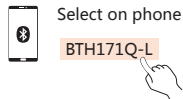

### 4 Role switch

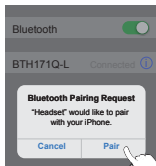

Click pair button to achieve role switch function

TIPS: Operations can be performance on either earbuds, unless the one we specified can only be operated on L or R.

## Controls for music



double-click



click and hold



click and hold



click



click

## Controls for calling

Cancel dial



click

Reject



click and hold

Answer



click

Hang up



double-click

Transfer audio



click and hold

Voice assistant



triple-click



click

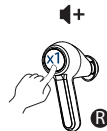

click

## ⚠ Manual operation

🔌 on



click and hold

TIPS: white LED flashes

🔌 off



click and hold

TIPS: red LED flashes

Enter pairing mode

(The current state is power off)



click and hold

TIPS: red and white LED quickly flash alternately

Factory reset

(The current state is pairing)



click five times

TIPS: red and white LED are on for 1 second at the same time

## The battery status of charging case

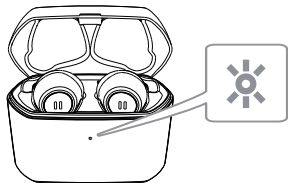

LED flashes once every 2 seconds



LED flashes three times every 2 seconds



LED remains on

## Charging



Micro USB charging



Wireless charging

## Wearing schematic

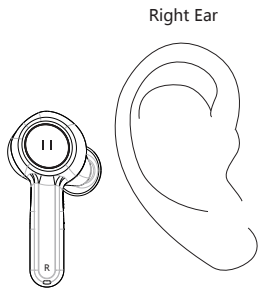

- ① Choose the right earphone to match the ear

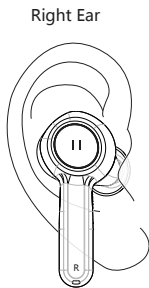

- ② Align the earphone with the ear and insert the eartip into the ear hole

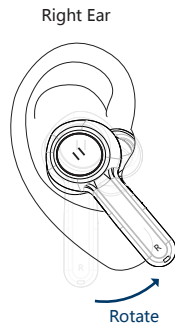

- ③ Rotate the earphone to a comfortable position